



jordan fishwick

1 Oak Road Lindow Court Park, Mobberley,
Guide Price £240,000

Lindow Court Park Knutsford

Guide Price £240,000



Take a look at this brand-new park home for the over-45s, ideally positioned in a highly sought-after semi-rural location. Internally, the property offers two well-proportioned bedrooms, a generous open-plan dining and kitchen area, well proportioned lounge and a stylish three-piece shower room suite as well as the master bedroom benefiting from it's own en-suite. The spacious kitchen/diner is both attractive and practical, featuring a range of modern matching wall and base units alongside integrated appliances. Both bedrooms benefit from built-in wardrobes, providing excellent additional storage space. Externally, the home enjoys an enclosed fenced perimeter and a paved pathway, creating a private and low-maintenance outdoor space. Must view!





- Brand-New Park Home
- Two Bedrooms
- Two Shower Rooms
- Semi-Rural Location
- Lindow Court Park
- Must View

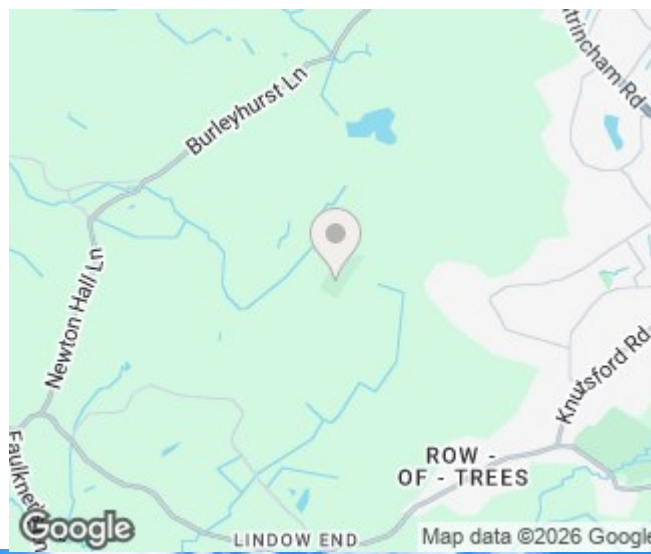

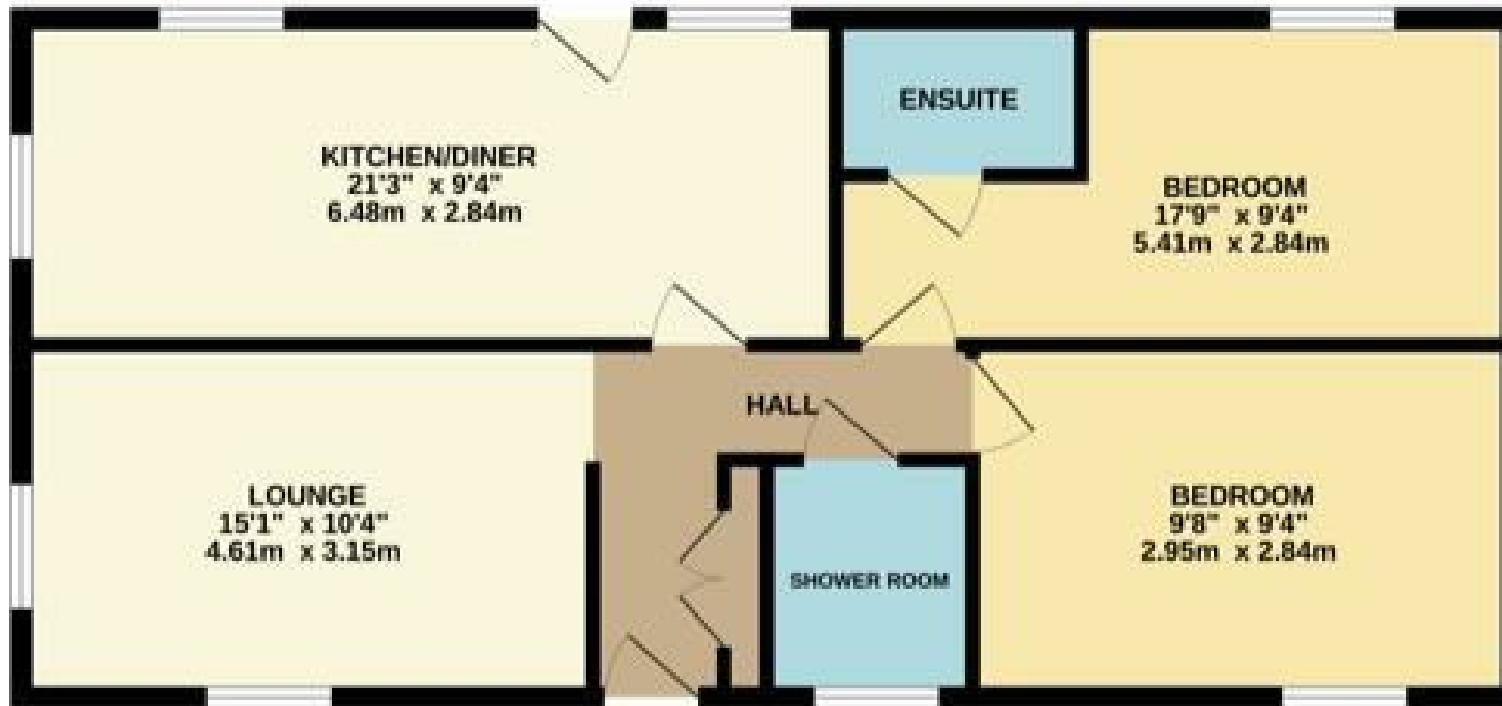

Measurements are approximate, not to scale. Dimensions represent only
 Made with Blueprints 2020



These particulars are believed to be accurate but they are not guaranteed and do not form a contract. Neither Jordan Fishwick nor the vendor or lessor accept any responsibility in respect of these particulars, which are not intended to be statements or representations of fact and any intending purchaser or lessee must satisfy himself by inspection or otherwise as to the correctness of each of the statements contained in these particulars. Any floorplans on this brochure are for illustrative purposes only and are not necessarily to scale.

Offices at: Chorlton, Didsbury, Disley, Hale, Glossop, Macclesfield, Manchester Deansgate, Manchester Whitworth Street, New Mills, Sale, Wilmslow and Withington

36-38 Alderley Road, Wilmslow SK91JX
01625 532000

wilmslow@jordanfishwick.co.uk
 www.jordanfishwick.co.uk